

MC30  
012

Muro MC30  
1 : 10

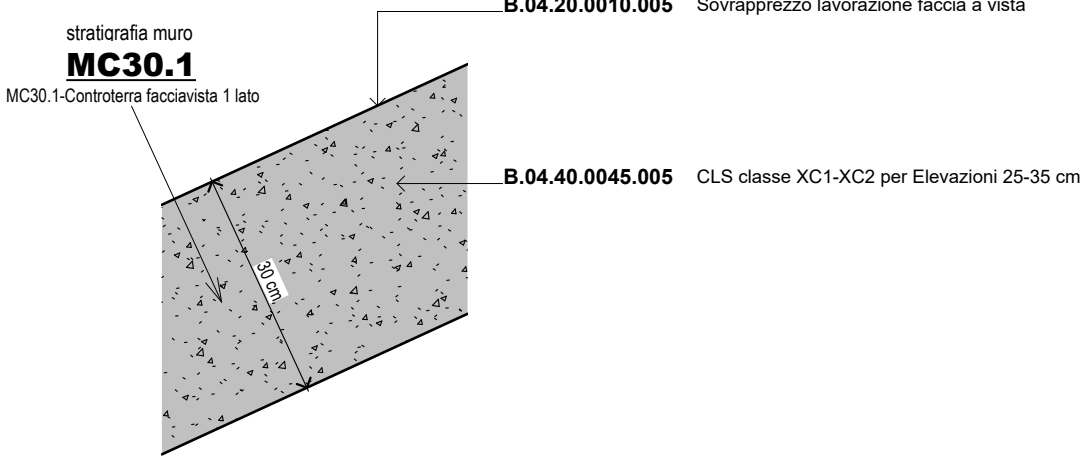

MC30.1  
012

Muro MC30.1  
1 : 10

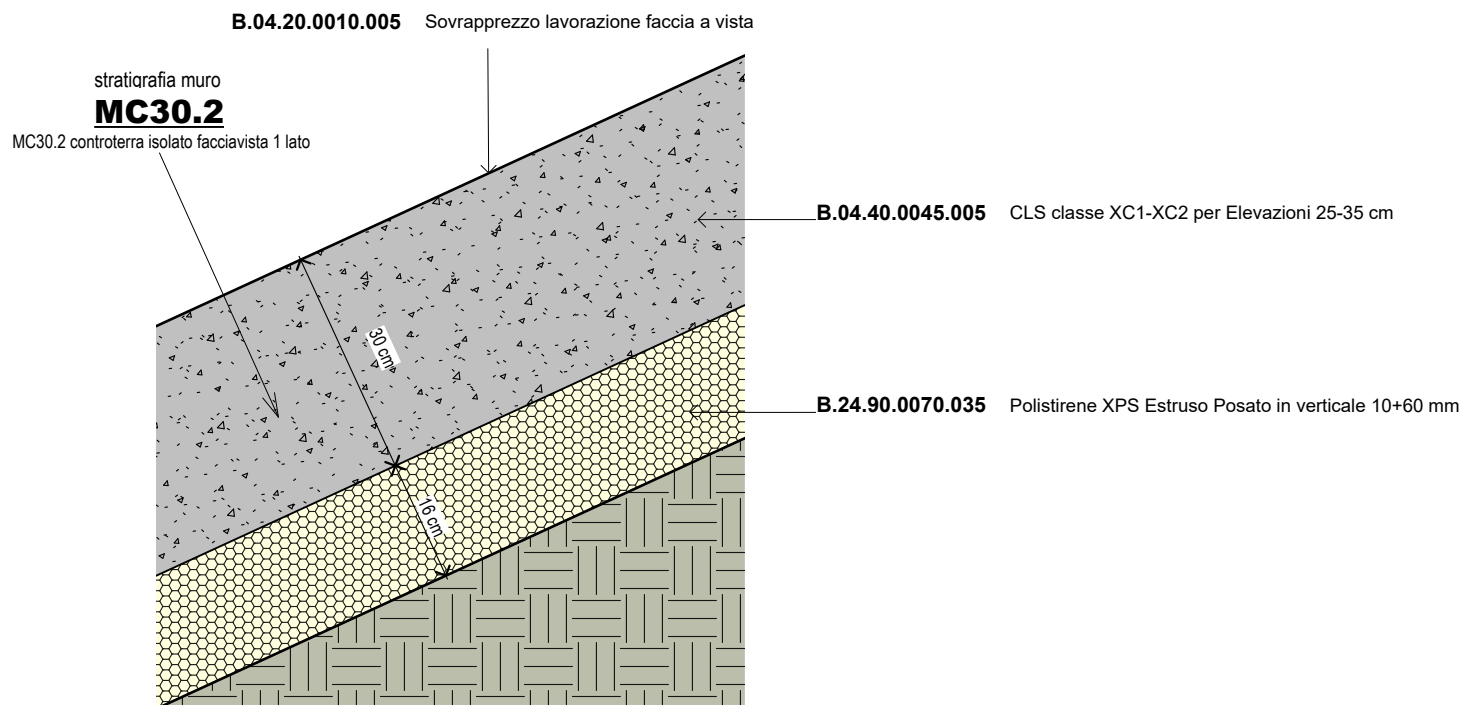

MC30.2  
012

Muro MC30.2  
1 : 10

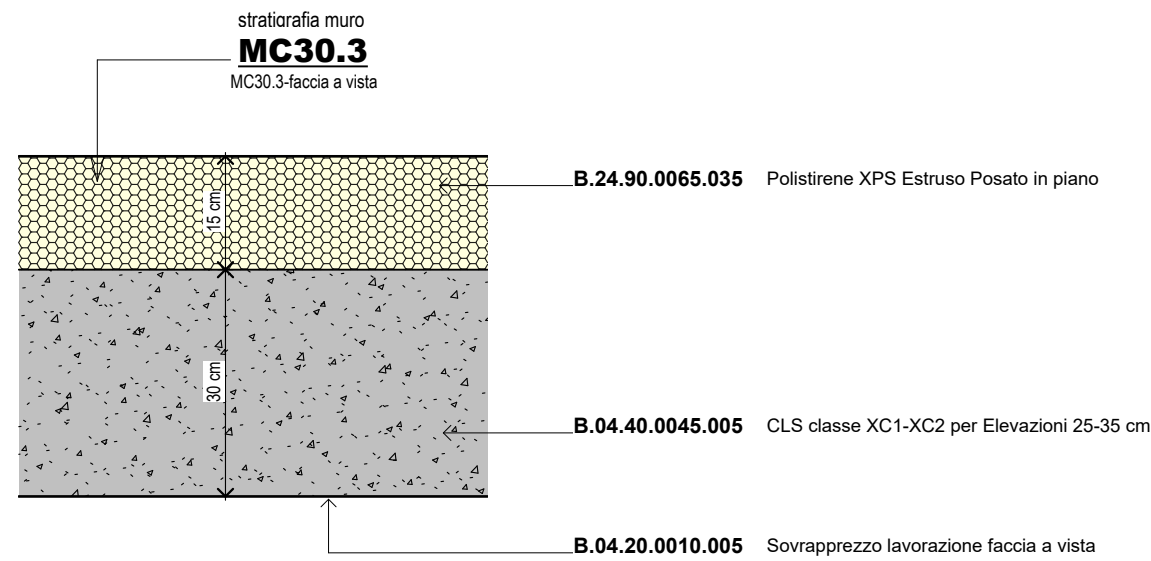

MC30.3  
012

Muro MC30.3  
1 : 10

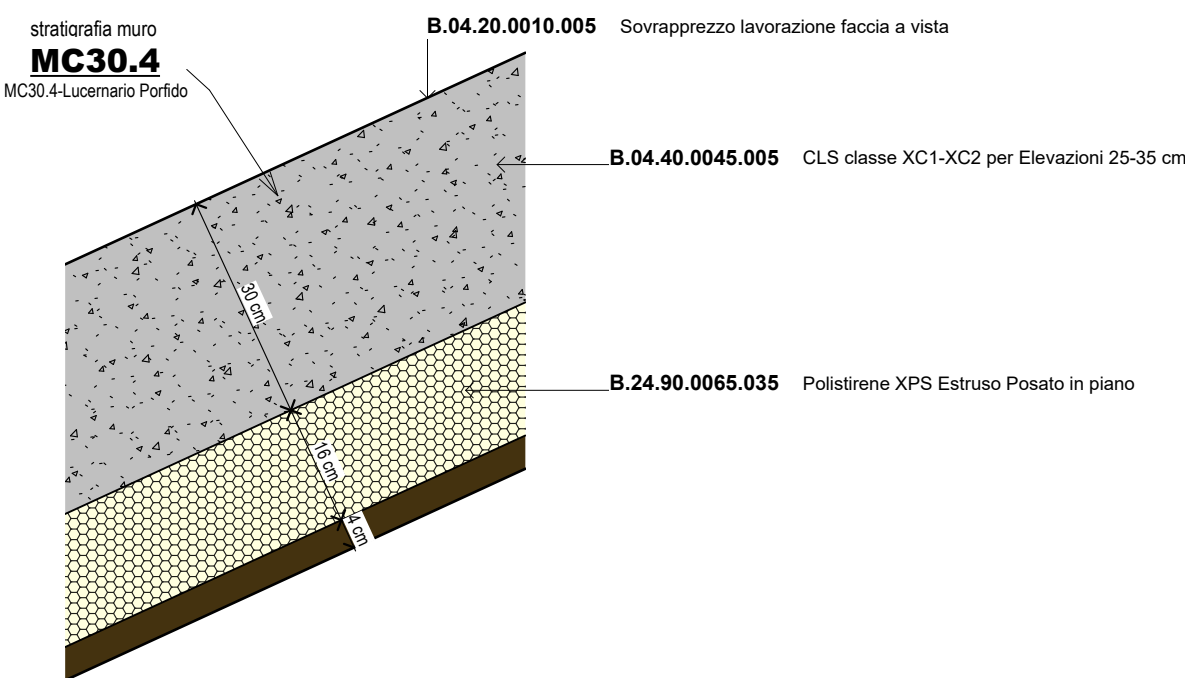

MC30.4  
012

Muro MC30.4  
1 : 10

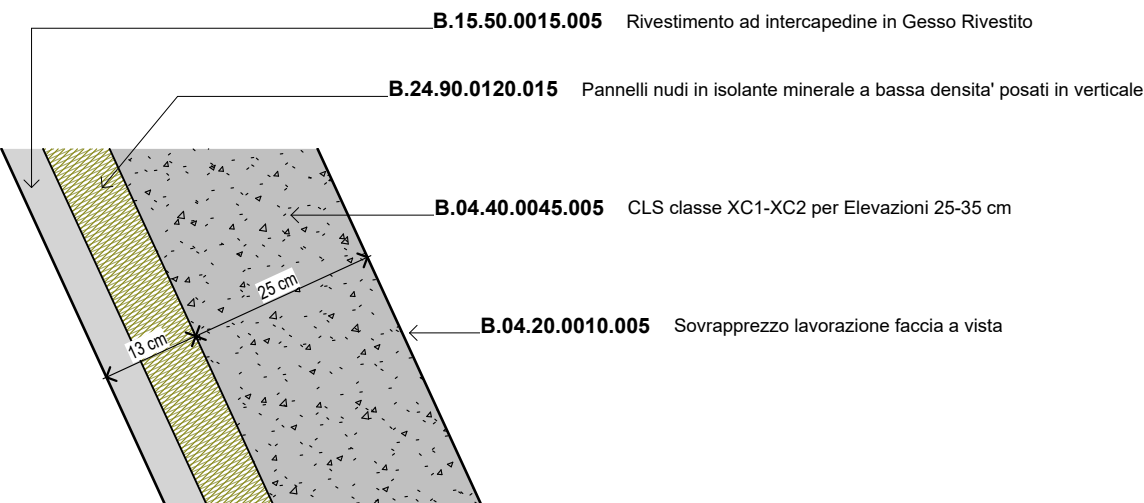

MC25  
012

Muro MC25  
1 : 10

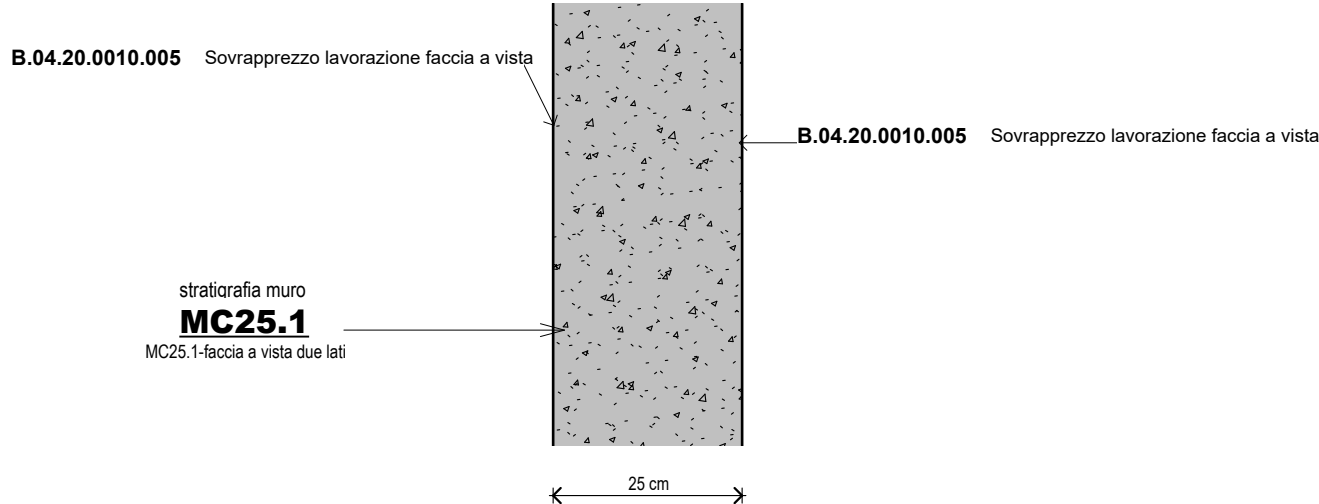

MC25.1  
012

Muro MC25.1  
1 : 10

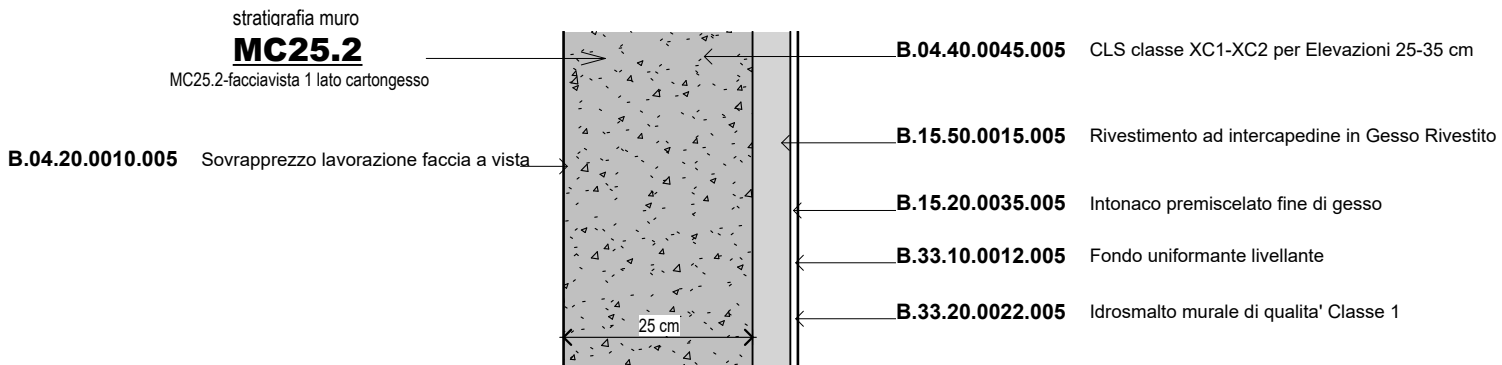

MC25.2  
012

Muro MC25.2  
1 : 10

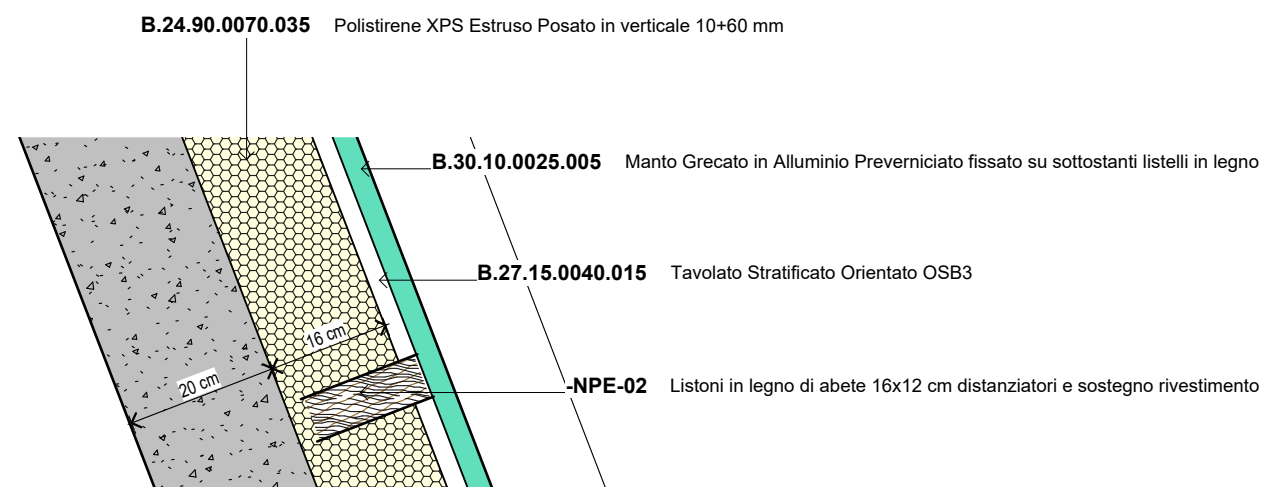

MC20.3  
012

Muro MC20.3  
1 : 10

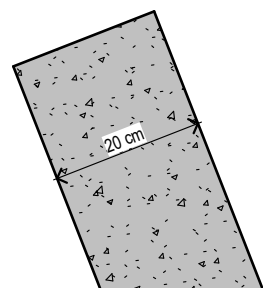

MC20  
012

Muro MC20  
1 : 10

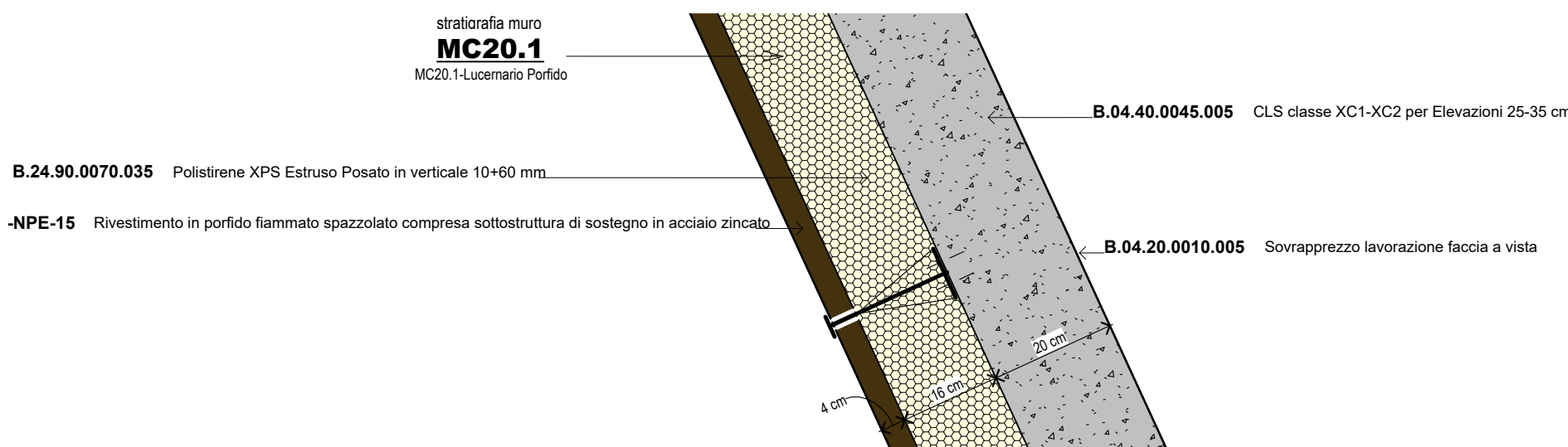

MC20.1  
012

Muro MC20.1  
1 : 10

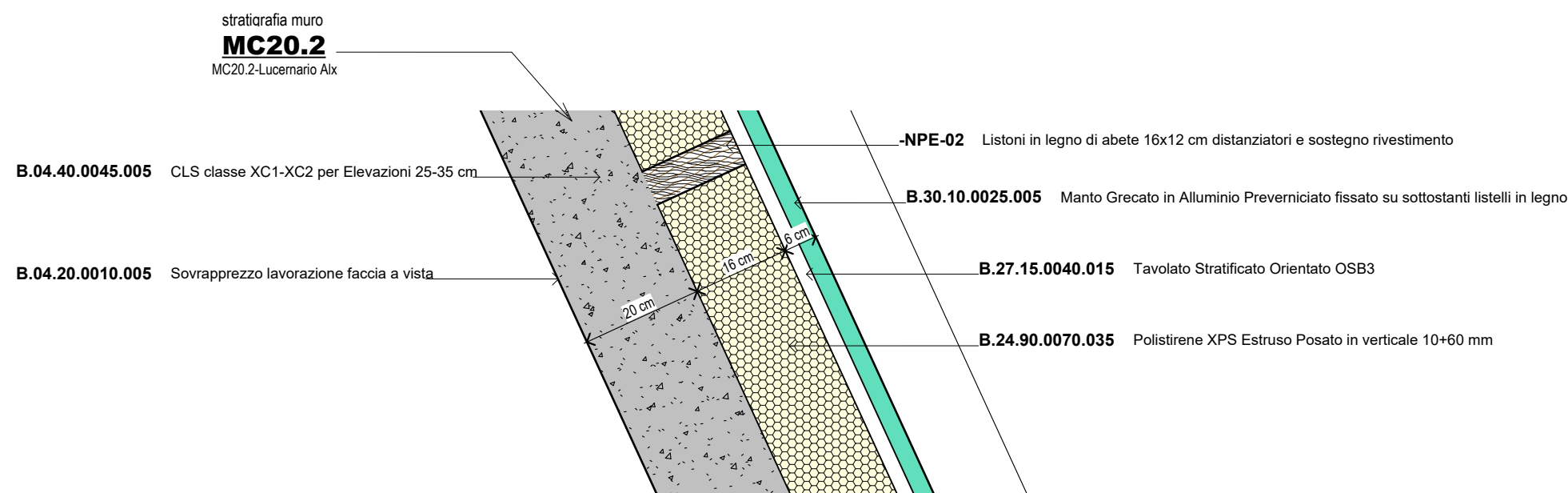

MC20.2  
012

Muro MC20.2  
1 : 10

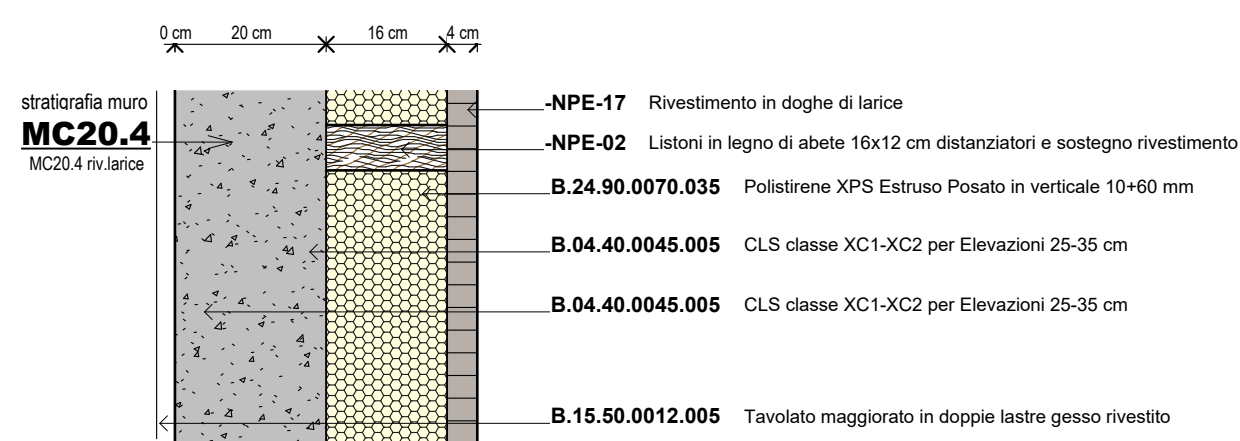

MX11  
012

Muro MC20.4  
1 : 10

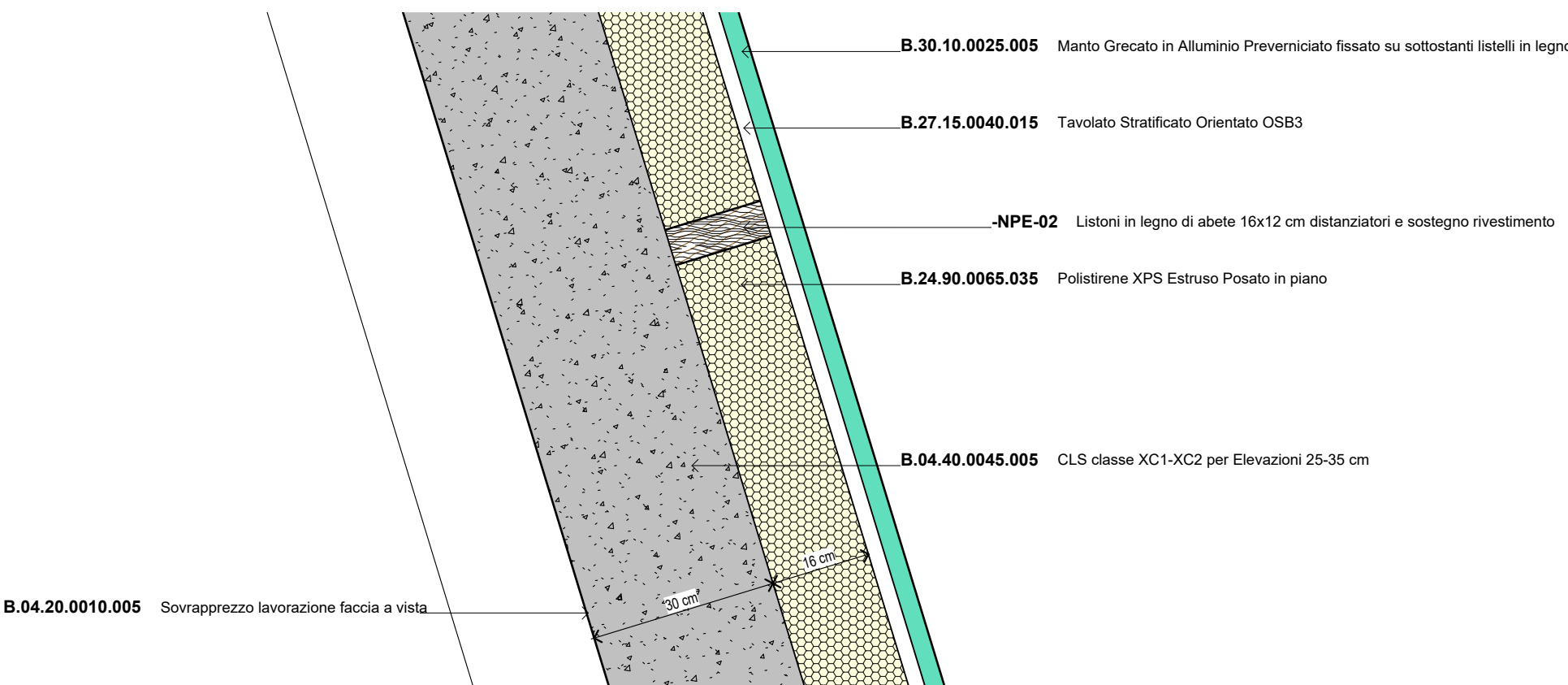

MC30x  
012

Muro MC30.x  
1 : 10

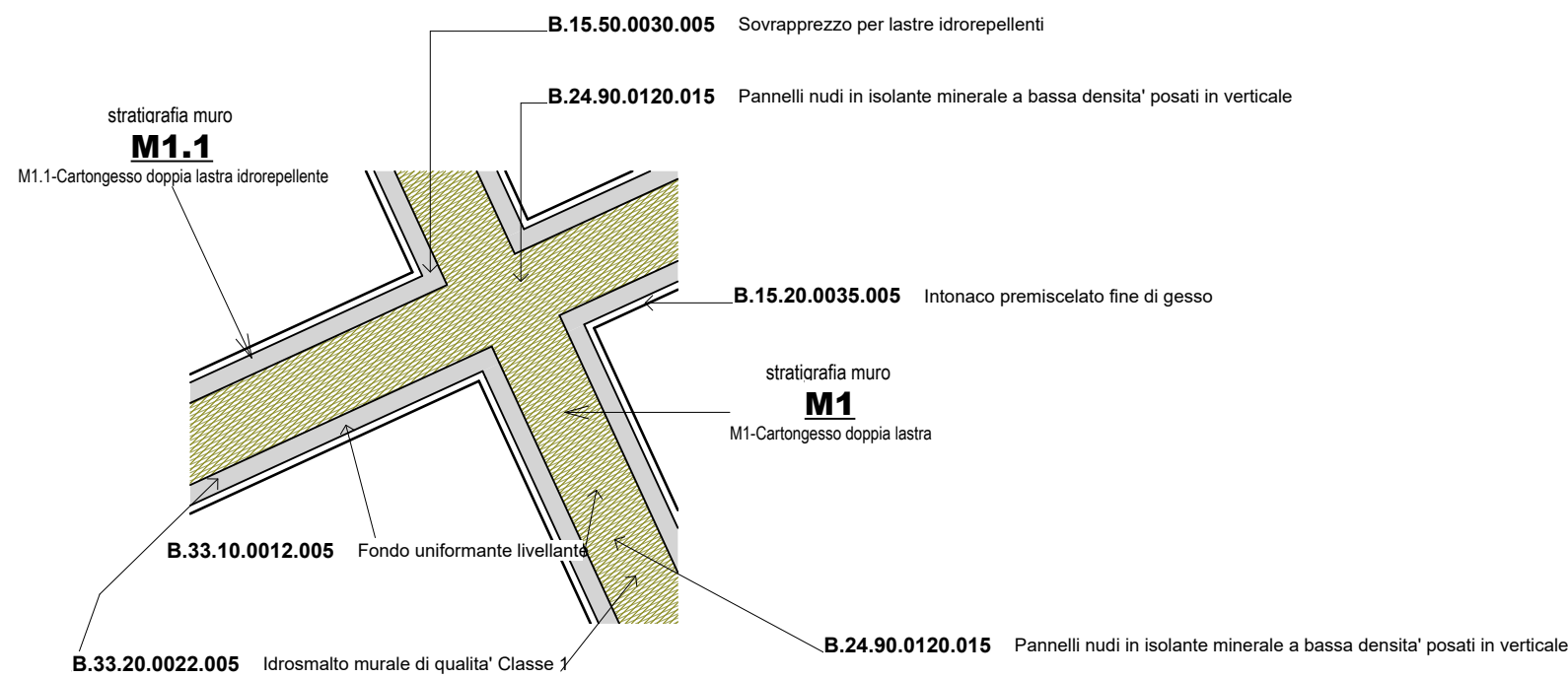

M1  
012

Muri M1-M1.1  
1 : 10

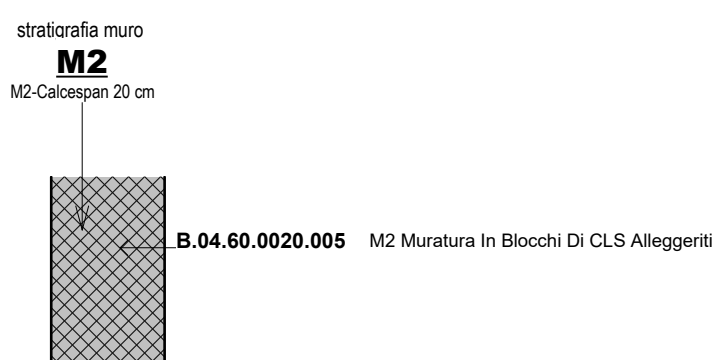

M2  
012

Muro M2  
1 : 10

<div><div></div><div><div>PROVINCIA AUTONOMA DI TRENTO</div><div>AGENZIA PROVINCIALE OPERE PUBBLICHE</div><div>SERVIZIO OPERE CIVILI</div><div>UFFICIO PROGETTAZIONE E DIREZIONE LAVORI</div></div></div>									
<div><div></div><div><div>COMUNE DI TESERO</div><div>LAVORI PUBBLICI E AMBIENTE</div></div></div>									
<div><div></div><div><div>Lavori di adeguamento dello stadio del fondo a Lago di Tesero</div><div>UF1-A</div></div></div>									
FASE PROGETTO: PROGETTO ESECUTIVO									
CATEGORIA: ARCHITETTURA									
TITOLO TAVOLA: Nuovo Interrato Stratigrafia Muri									
C. SIP: E-90/000	C. SOC: 5360	1 : 10	FASE PROGETTO: E	TIPO ELAB.: T	CATEGORIA: 312	PARTE D'OPERA: UF1	N° PROGR: 012	REVISIONE: REV.1	
PROGETTO ARCHITETTONICO: arch. Marco GIOVANAZZI			PROGETTO STRUTTURE e ANTINCENDIO: ing. Marco SONTACCHI			Visto IL DIRIGENTE: ing. Marco GELMINI			
PROGETTO IMPIANTI ELETTRICI: ing. Renato COSER			PROGETTO IMPIANTI TERMOMECCANICI: ing. Giovanni BETTI			Visto IL DIRETTORE DELL'UFFICIO : arch. Silvano TOMASELLI IL COORDINATORE DEL GRUPPO DI PROGETTO: ing. Gabriele DEVIGILI			
CSP : ing. Pietro MATTIOLI			RELAZIONE GEOLOGICA: geol. Mirko DEMOZZI			RELAZIONE ACUSTICA: ing.. Matteo AGOSTINI			
NOME FILE: Autodesk Docs\\Centro Fondo Tesero MICO 2026\\Tesero Interrato ARCH ESE.rvt							DATA REDAZIONE: 01/03/2023 16:28:38		